

SITE
3465 Allan Industrial Dr.

3675 Allan Industrial Dr.

WAREHOUSE/OFFICE BUILDING | FOR LEASE

3465 ALLAN INDUSTRIAL DR., EL RENO, OK

KRIS DAVIS, SIOR
kgdavis@newmarkrp.com
C: 405.202.9525

BRETT PRICE, CCIM, SIOR
bprice@newmarkrp.com
C: 405.613.8380

KARLEY HARPER, CCIM
kharper@newmarkrp.com
C: 405.371.3498

NEWMARK
ROBINSON PARK

WAREHOUSE/OFFICE BUILDING / FOR LEASE

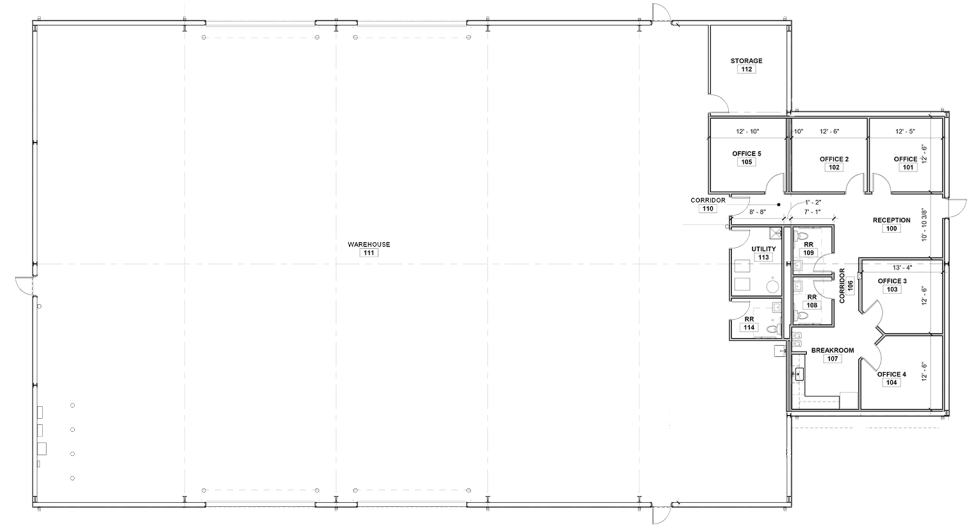

FLOOR PLAN 

DETAILS

Available SF	10,817 SF
Lease Rate	\$15,000/MO (NNN)
Building Size	10,817 SF
Lot Size	4.5 Acres expandable to 11 Acres
Submarket	El Reno
Cross Streets	Hwy 66 & N Banner Rd.

HIGHLIGHTS

9,135 SF warehouse/storage space
1,682 SF office space
(4) 18' x 18' overhead doors
28' clear height
5 offices, reception area, and break room
Fenced and graveled yard

PROPERTY OVERVIEW

Newly constructed industrial building located in a well-established and expanding industrial corridor servicing Canadian and Kingfisher counties. The property is less than 1 mile to I-40, with easy access to STACK & SCOOP oil plays.